

# 99/The Atrium Hucknall Road

## Local Heritage Asset Register

### Berridge

HA228

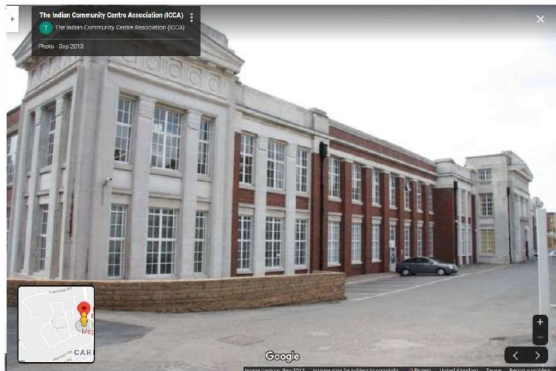

<b>Status:</b>	Recommendation to add
<b>Age:</b>	Early to Mid-20th Century
<b>Conservation Area:</b>	No
<b>Date added to the list:</b>	
<b>Condition:</b>	Fair

### Assessment against Local Criteria

- 1 Age: 1914-1960
- 2 Good quality Neo-Classical Design
- 3 Associated with a good local architectural practice
- 4 Office block to the first purpose-built printing works nationally

### Reason for Designation

Office wing of the earliest surviving purpose-built printing factory in the country built in a refined Neo-Classical style by an important local practice

### Local List Proposal



### Description

Office wing to the formerly the Thomas Forman & Sons printing factory, 1926 by Evans, Clark and Woollatt. The first purpose built printing factory in the country. All except the office wing was demolished in 2001. Wide, symmetrical, giant order frontage with central Doric portico. Brick and Portland Stone with large steel framed windows. Original decorative railings and gates with company crest survive in good condition along road frontage. The factory closed in 1998.

# 99/The Atrium Hucknall Road

## Local Heritage Asset Register

### Berridge

HA228

#### Additional Description:

Further information at <http://thosforman-preservation-society.org.uk/>

During the last 52 years of the Company's existence, many changes and developments took place at the factory in Hucknall Road until its eventual closure. At its peak Forman's employed over 1,000 people.

There were several divisions of the Company which produced general print, labels, cartons, calendars, stationery and security print. Each division had its own sales force and at the height of the Company's success, there were area sales offices in London, Liverpool and Birmingham.

The factory at Hucknall Road consisted of a number of departments printing by letterpress, litho, gravure and die-stamping processes. The Company also had its own Design Studio, Composing, Reproduction, Finishing, Laboratory, Engineering and Personnel departments.

Heritage category:	Building
Asset type:	Industrial
Original use:	Office
Current use:	Office
Currently occupied:	Yes
Architect, style / material:	Evans, Clark and Woollatt
Condition:	Fair

#### Part of a group of heritage assets:

#### Associated with historical events or people:

#### Is it associated with any buried remains or archaeology? If so please describe:

#### How is it of importance to the local community? :

The building has been the Indian Community Centre Association since 2003

<b>Selection Panel Date:</b>	<b>Date added to the list:</b>
05/11/2019	

# Former White Horse PH Ilkeston Road

## Local Heritage Asset Register Radford

HA235



<b>Status:</b>	Recommendation to add
<b>Age:</b>	Edwardian to WW1
<b>Conservation Area:</b>	No
<b>Date added to the list:</b>	
<b>Condition:</b>	Good

### Assessment against Local Criteria

1. Good example of an Edwardian Public House
2. High aesthetic Value
3. Historical Association with a nationally significant literary figure

### Reason for Designation

As a good example of Edwardian public house with high aesthetic value and association with Alan Sillitoe.

### Local List Proposal

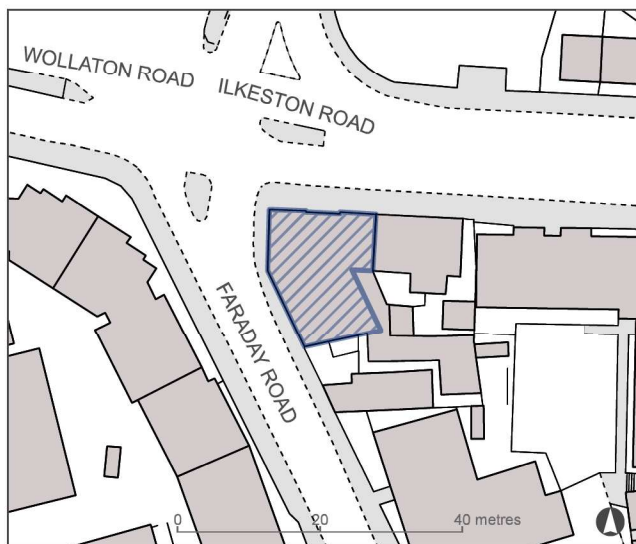

### Description

1912, Fredk Ball for Mr W Tomlin (WT monogram visible.) Dutch gables on main frontage, 2 central doors, RH one leading to Jug & Bottle. Green glazed tiles. A Civic Society plaque marks Alan Sillitoe associations. CAMRA.

# Former White Horse PH Ilkeston Road

## Local Heritage Asset Register

Radford

HA235

Additional Description:

Heritage category:	Building
Asset type:	Commercial
Original use:	
Current use:	Restaurant or Cafe
Currently occupied:	
Architect, style / material:	Fredk Ball for Mr W Tomlin
Condition:	Good

Part of a group of heritage assets:

Associated with historical events or people:

Is it associated with any buried remains or archaeology? If so please describe:

How is it of importance to the local community? :

<b>Selection Panel Date:</b>	<b>Date added to the list:</b>
05/03/2019	

# Pryzm Lower Parliament Street

## Local Heritage Asset Register Castle

HA256



<b>Status:</b>	Recommendation to add
<b>Age:</b>	Late 20th Century
<b>Conservation Area:</b>	No
<b>Date added to the list:</b>	
<b>Condition:</b>	Fair

### Assessment against Local Criteria

1. Age: 1914-1960
2. High Aesthetic value - especially the Baroque frontage
3. High Communal Value as the Palais de Danse

### Reason for Designation

As an example of a 1920s Dance Hall with high aesthetic value

-  Local List Proposal
-  Conservation Areas

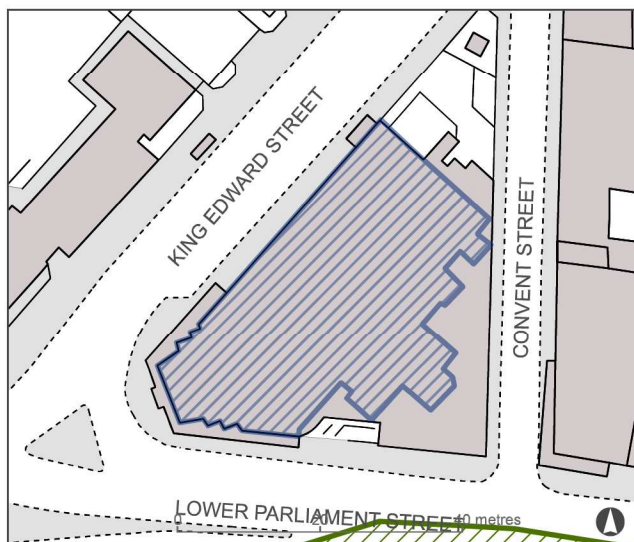

### Description

Palais de Danse by Thraves & Dawson 1924-5. Nice frieze over entrance and good example of early 20th century Baroque. The interior appears to have been heavily altered. Now used as a nightclub.

# Pryzm Lower Parliament Street

## Local Heritage Asset Register

Castle

HA256

Additional Description:

Heritage category:	Building
Asset type:	Cultural & Entertainment
Original use:	
Current use:	Cultural or Entertainment
Currently occupied:	Yes
Architect, style / material:	Thraves & Dawson 1924-5
Condition:	Fair

Part of a group of heritage assets:

Associated with historical events or people:

Is it associated with any buried remains or archaeology? If so please describe:

How is it of importance to the local community? :

<b>Selection Panel Date:</b>	<b>Date added to the list:</b>
22/08/2019	

# Former tram shed

## Local Heritage Asset Register

### St Ann's

HA387



<b>Status:</b>	Recommendation to add
<b>Age:</b>	Victorian (1837-1901)
<b>Conservation Area:</b>	No
<b>Date added to the list:</b>	
<b>Condition:</b>	Good

### Assessment against Local Criteria

1. Age: 1840-1914
2. High Aesthetic Value
3. Good example of an urban power station and an important survival of late Victorian or Edwardian tram infrastructure

### Reason for Designation

Good aesthetic survival demonstrating late Victorian and Edwardian tram infrastructure

### Local List Proposal

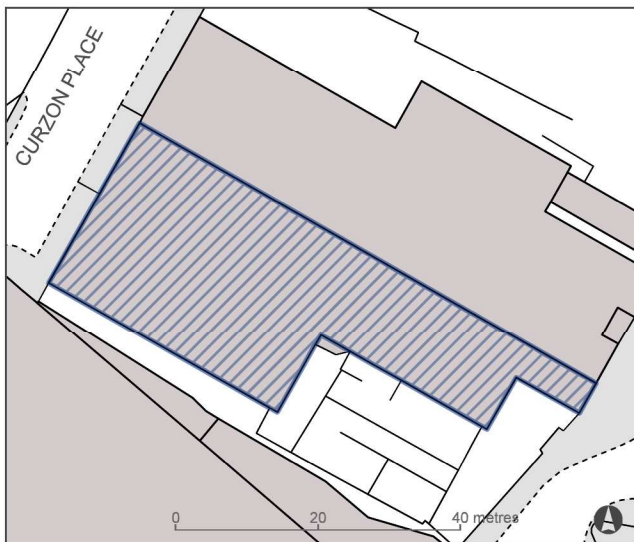

### Description

Tram Power Station built in the 1890s/1900s in an attractive mixed Jacobean and Classical style with brick and stone dressings. The Power Station extended over two modern properties. This entry represents the original Power Station with an extension to the north which was later much altered and converted to a dance hall.

# Former tram shed

## Local Heritage Asset Register

St Ann's

HA387

Additional Description:

Heritage category:	Building
Asset type:	Transport
Original use:	
Current use:	Sport or Recreation
Currently occupied:	Yes
Architect, style / material:	
Condition:	Good

Part of a group of heritage assets:

Associated with historical events or people:

Is it associated with any buried remains or archaeology? If so please describe:

How is it of importance to the local community? :

<b>Selection Panel Date:</b>	<b>Date added to the list:</b>
07/05/2019	